

Detached Garage Specifications for:

Name: _____
Address: _____

Legal Land Location: _____
Phone: _____ Fax: _____
Contractor: _____ Phone: _____

Specifications

Foundation (grade beam & piles) or Slab (Page 3)
Slab dimensions: _____ wide x _____ long
Slab thickness overall _____ perimeter _____ (See page 3 for detail)
Type of base _____

Walls
Size & spacing of studs: _____
Size, type & spacing of anchor bolts: _____
Wall/building height to eave: _____ Type of siding: _____
Thickness & type of wall sheeting: _____
Insulation & barrier: Yes ___ No ___
Inside finish: _____ None _____

***Size of each vehicle door: Door #1** - Opening width _____ & Header size _____ ply of 2" x _____
Door #2 - Opening width _____ & Header size _____ ply of 2" x _____ **Door #3** - Opening width _____ & Header size _____ ply of 2" x _____
***Size of windows/man doors & header: 1.** - Opening width _____ & Header size _____ ply of 2" x _____
2. - Opening width _____ & Header size _____ ply of 2" x _____ **3.** - Opening width _____ & Header size _____ ply of 2" x _____

**Note door/window openings on attached sketch, page 2.*

Permit # _____
Town/Village/RM of _____
Date: _____

Wagner Inspection Services
Contact Dale
@
225-2265 / 241-4741
wagnerdp@sasktel.net

Roof
Engineered trusses by: _____
Spacing of trusses: _____ & overhang: _____
Type of shingles: _____
Ceiling finish: _____
Insulation: _____

Other
Heating: _____
Electrical: _____
Pit or Hoist: _____
Recommend eavetroughs and downspouts

- Site Plan (on the reverse side show the following):**
1. Lot dimensions & lot shape
 2. Garage location and set backs from lot lines
 3. All existing buildings, their dimensions & distance to garage.
 4. Location of easements, retaining walls & driveways

Roof Layout

Indicate the location & *size of all doors and windows* and the direction of the roof peak in the drawing below:

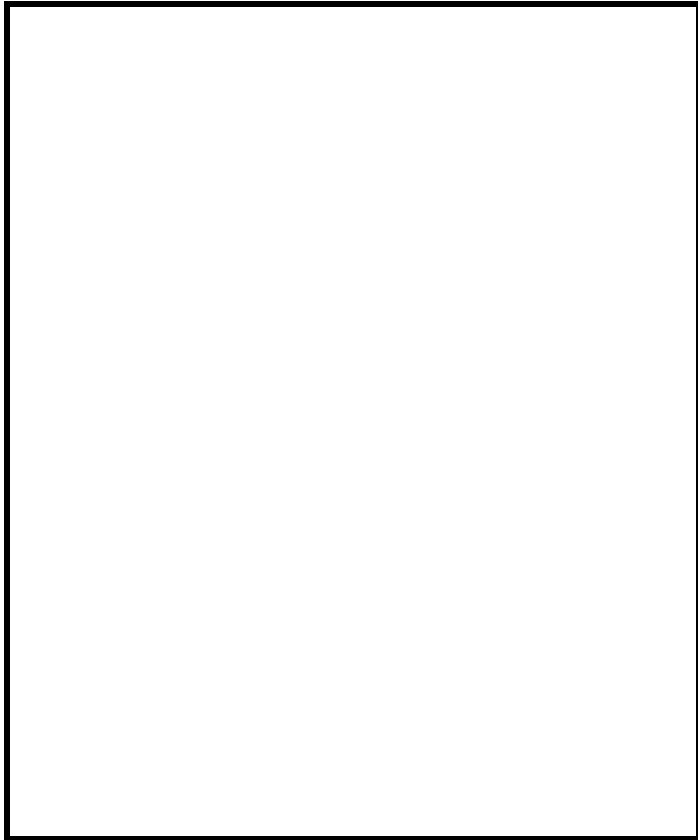

Wagner Inspection Services
 Contact Dale @ 225-2265 / 241-4741
 wagnerdp@sasktel.net

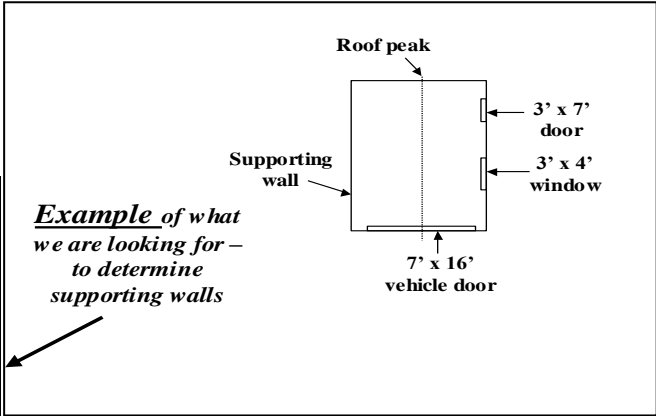

Note: venting & attic hatch required if insulating

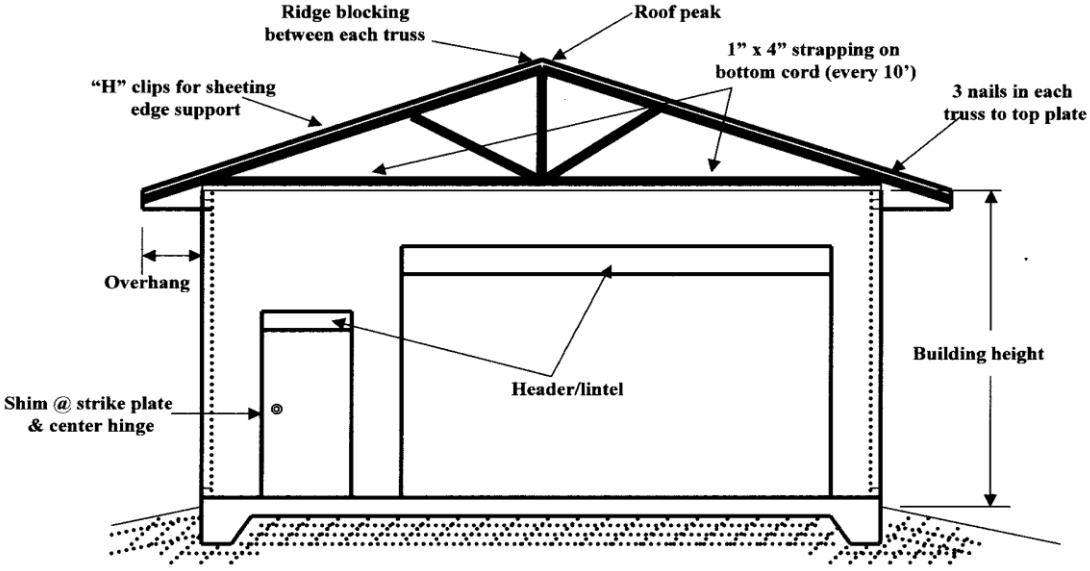

Recommended Reinforced Thickened Edge Concrete Slab

Wagner Inspection Services

Contact Dale

@

225-2265 / 241-4741

wagnerdp@sasktel.net

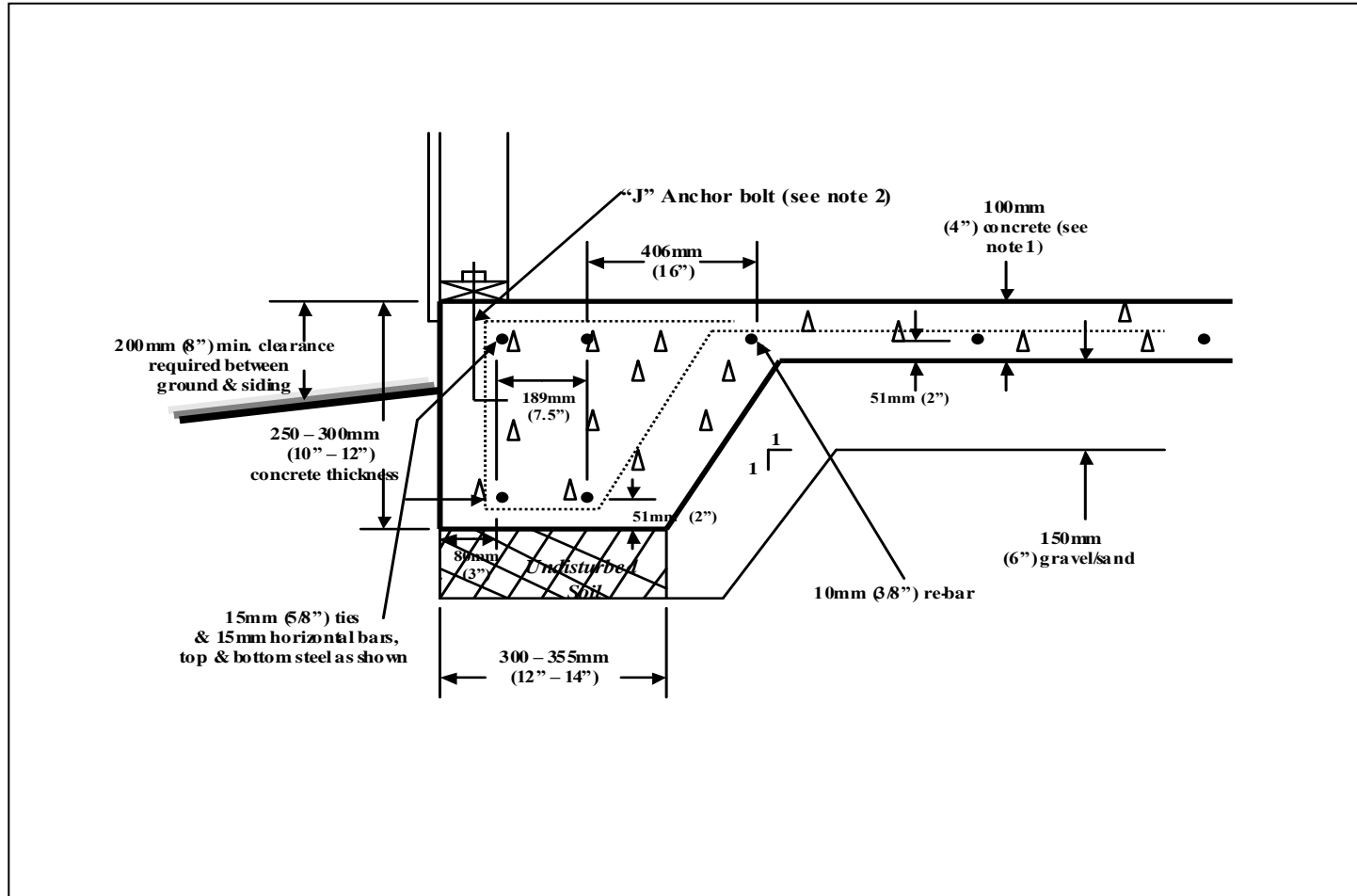

Notes:

- 102mm (4") thick reinforced concrete slab with 10mm (3/8") dia re-bar at 406mm (16") on center each placed on:
 - 6 mil poly cover and (as per CGS B51.34M)
 - 152mm (6") deep compacted gravel base.
- Around the perimeter place 12.7,, (1/2") x 203mm (5") anchor bolts or equivalent at 900mm to 1200mm (36" to 48") spacing