

# Schedule A: Rural Municipality of Dundurn No. 314

## Zoning District Map A

### Zoning Districts

- |  |  |                         |                     |   |
|--|--|-------------------------|---------------------|---|
| PR - Public Recreation District        | RR - Rural Residential District        | M - Industrial District | Main Roads          | RDA - Blackstrap Reservoir Development Area |
| CR - Commercial Recreation District    | AR - Agricultural Residential District | C - Commercial District | Secondary Roads     | Watercourse                                 |
| IR - Institutional Recreation District |  |                         | Railways            | Waterbody                                   |
|  |  |                         | Municipal Boundary  | Potential Flood Hazard Area                 |
|  |  |                         | Joint Planning Area | Urban Municipalities                        |

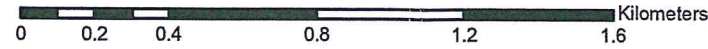

W3M

This is the Zoning District Map that accompanies Bylaw No. 69/2017 adopted by the R.M. of Dundurn No. 314

Administrator:

Reeve:



Seal

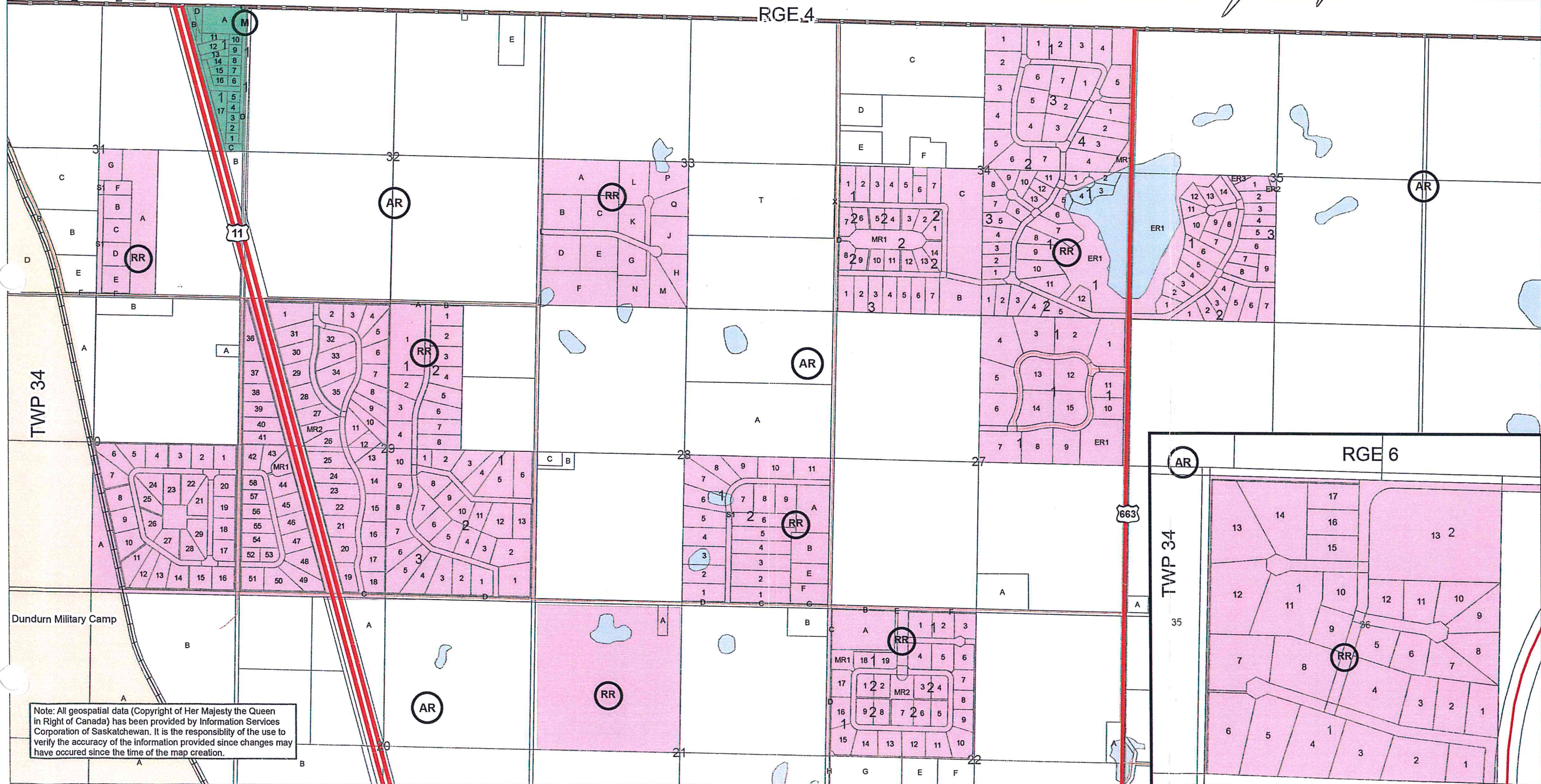











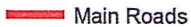



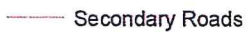

Note: All geospatial data (Copyright of Her Majesty the Queen in Right of Canada) has been provided by Information Services Corporation of Saskatchewan. It is the responsibility of the user to verify the accuracy of the information provided since changes may have occurred since the time of the map creation.

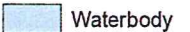
# Schedule A: Rural Municipality of Dundurn No. 314

## Zoning District Map B

### Zoning Districts

- |   |  |   |  |
|---|--|---|--|
|  PR- Public Recreation District    |  BR-Blackstrap Residential            |  Main Roads          |  RDA- Blackstrap Reservoir Development Area |
|  RR-Rural Residential District     |  M-Industrial District                |  Secondary Roads     |  Watercourse                                |
|  C-Commercial Recreation District  |  AR-Agricultural Residential Distirct |  Railways            |  Waterbody                                  |
|  Institutional Recreation District |  C-Commercial District                |  Municipal Boundary  |  Potential Flood Hazard Areas               |
|   |  |  Joint Planning Area |  Urban Municipalities                       |



W3M

This is the Zoning District Map that accompanies Bylaw No. 04/2017 adopted by the R.M. of Dundurn No. 314

Administrator

Reeve:

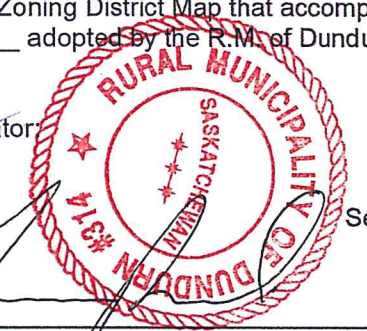

Seal

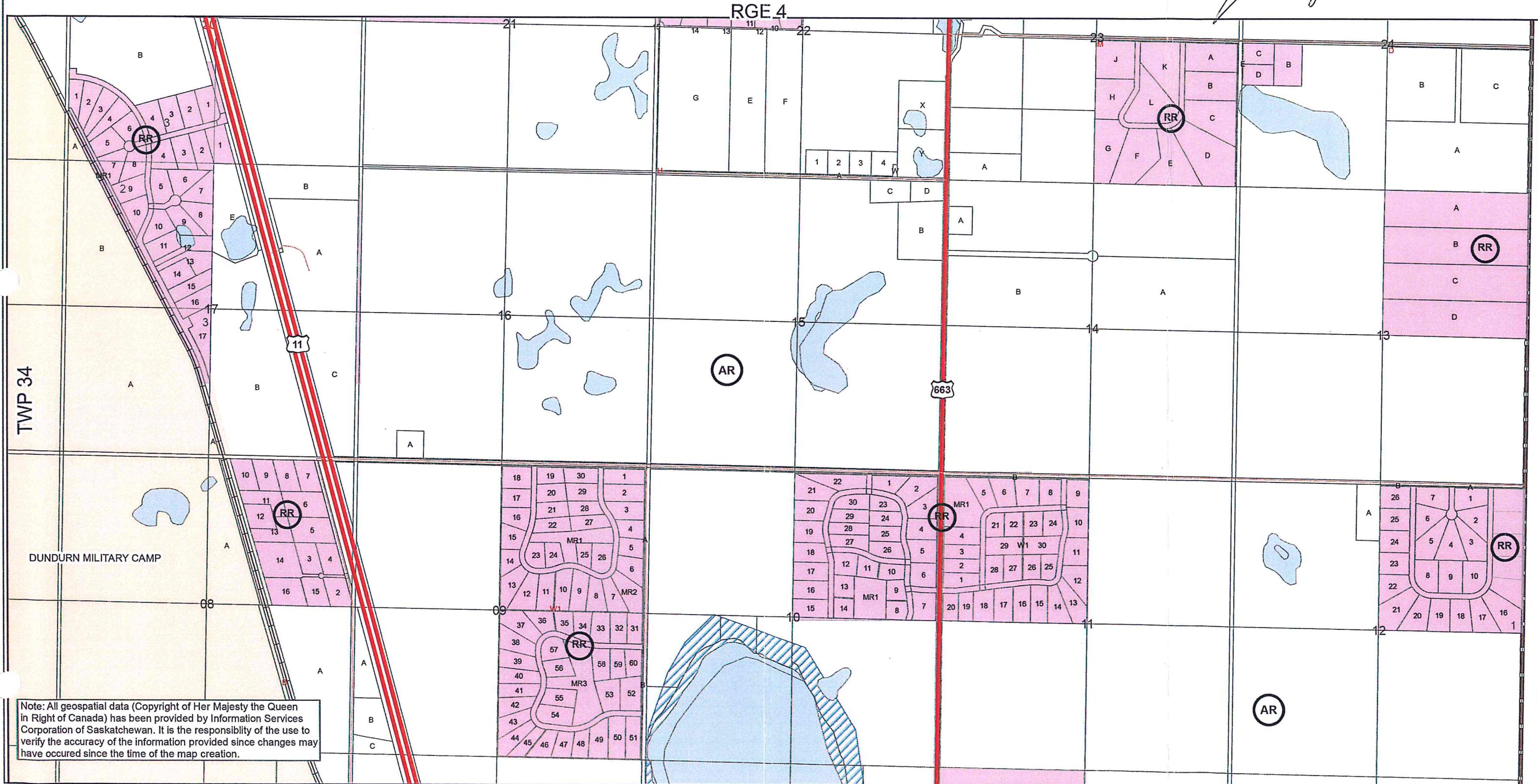

Note: All geospatial data (Copyright of Her Majesty the Queen in Right of Canada) has been provided by Information Services Corporation of Saskatchewan. It is the responsibility of the user to verify the accuracy of the information provided since changes may have occurred since the time of the map creation.

# Schedule A: Rural Municipality of Dundurn No. 314

## Zoning District Map



### Zoning Districts

- |  |  |
|--|--|
| PR- Public Recreation District         | Main Roads   |
| RR-Rural Residential District          | Secondary Roads                                    |
| CR - Commercial Recreation District    | Watercourse  |
| IR - Institutional Recreation District | Railways   |
| BR-Blackstrap Residential              | Joint Planning Area                                |
| M-Industrial District                  | Community Pasture                                  |
| AR-Agricultural Residential Distirct   | Blackstrap Provincial Park                         |
| C-Commercial District                  | Waterbody  |
|  | Potential Flood Hazard Areas                       |
|  | Potential Floodway South Saskatchewan River        |
|  | Potential Floodfringe for South Saskatchewan River |
|  | RDA-Blackstrap Reservoir Development Area          |
|  | Urban Municipalities                               |

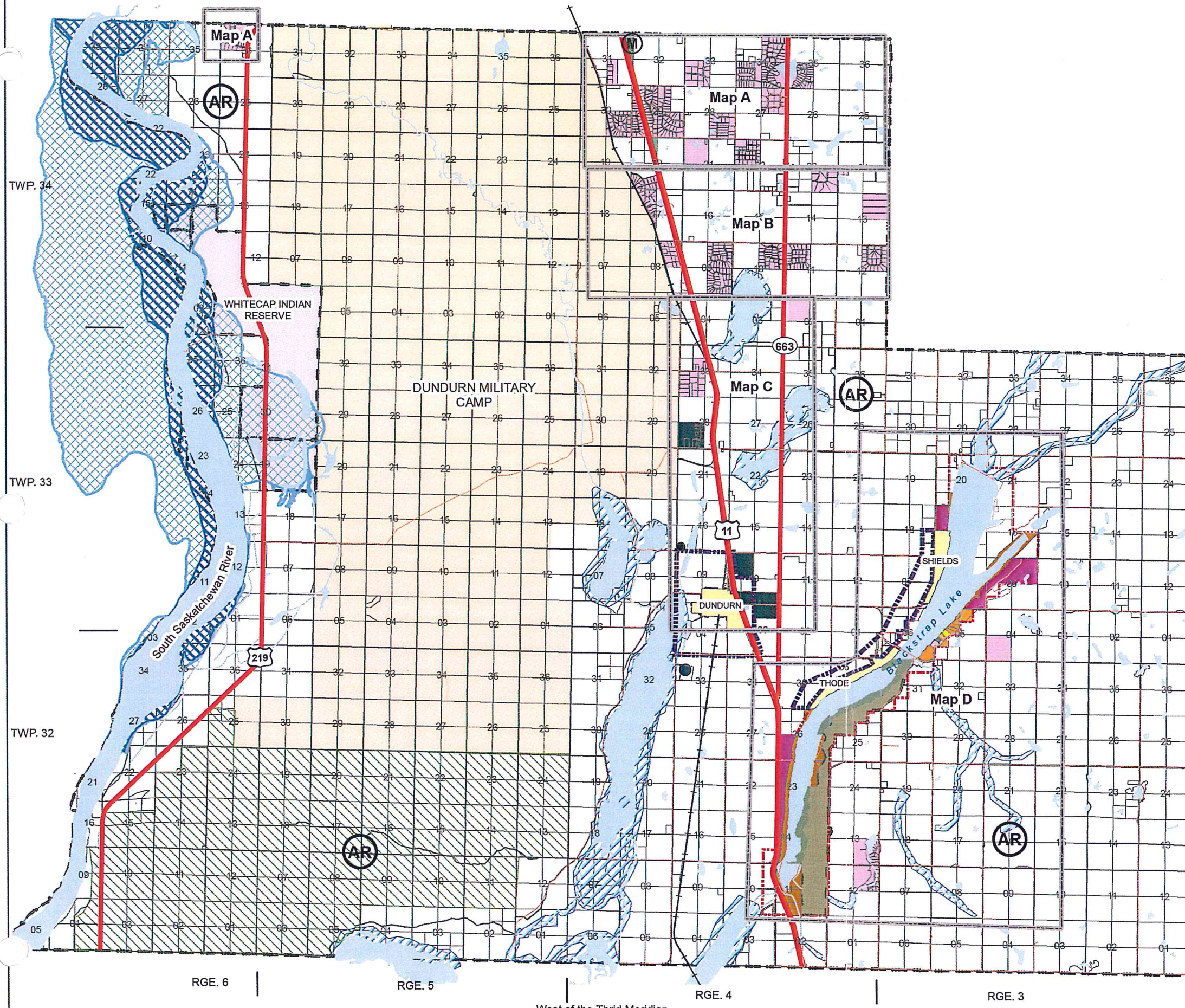

This is the Zoning District Map that accompanies Bylaw No. 09/2017 adopted by the R.M. of Dundurn No. 314

Admininstrator:

Reeve:



Note: All geospatial data (Copyright of Her Majesty the Queen in Right of Canada) has been provided by Information Services Corporation of Saskatchewan. It is the responsibility of the user to verify the accuracy of the information provided since changes may have occurred since the time of the map creation.

# Schedule A: Rural Municipality of Dundurn No. 314 Zoning Bylaw Map C

## Zoning Districts

- PR- Public Recreation District
- CR - Commercial Recreation District
- IR - Institutional Recreation District
- BR-Blackstrap Residential
- M-Industrial District
- AR-Agricultural Residential District
- C-Commercial District

- Main Roads
- Secondary Roads
- Railways
- Municipal Boundary
- Urban Municipalities
- RDA - Blackstrap Reservoir Development Area
- Watercourse
- Waterbody
- Potential Flood Hazard Areas
- Joint Planning Area

This is the Zoning District Map that accompanies Bylaw No. 09/2017 adopted by the R.M. of Dundurn No. 314

Administrator: \_\_\_\_\_

Reeve: \_\_\_\_\_



Seal



Note: All geospatial data (Copyright of Her Majesty the Queen in Right of Canada) has been provided by Information Services Corporation of Saskatchewan. It is the responsibility of the user to verify the accuracy of the information provided since changes may have occurred since the time of the map creation.

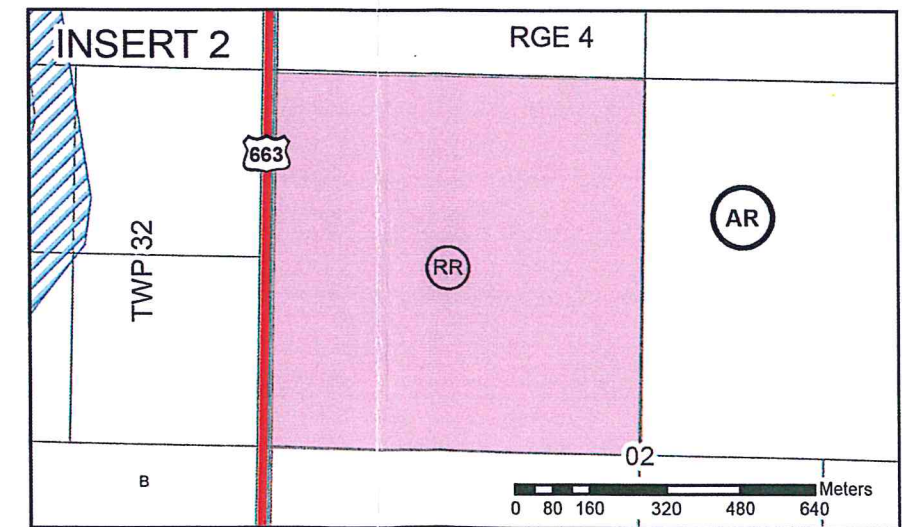
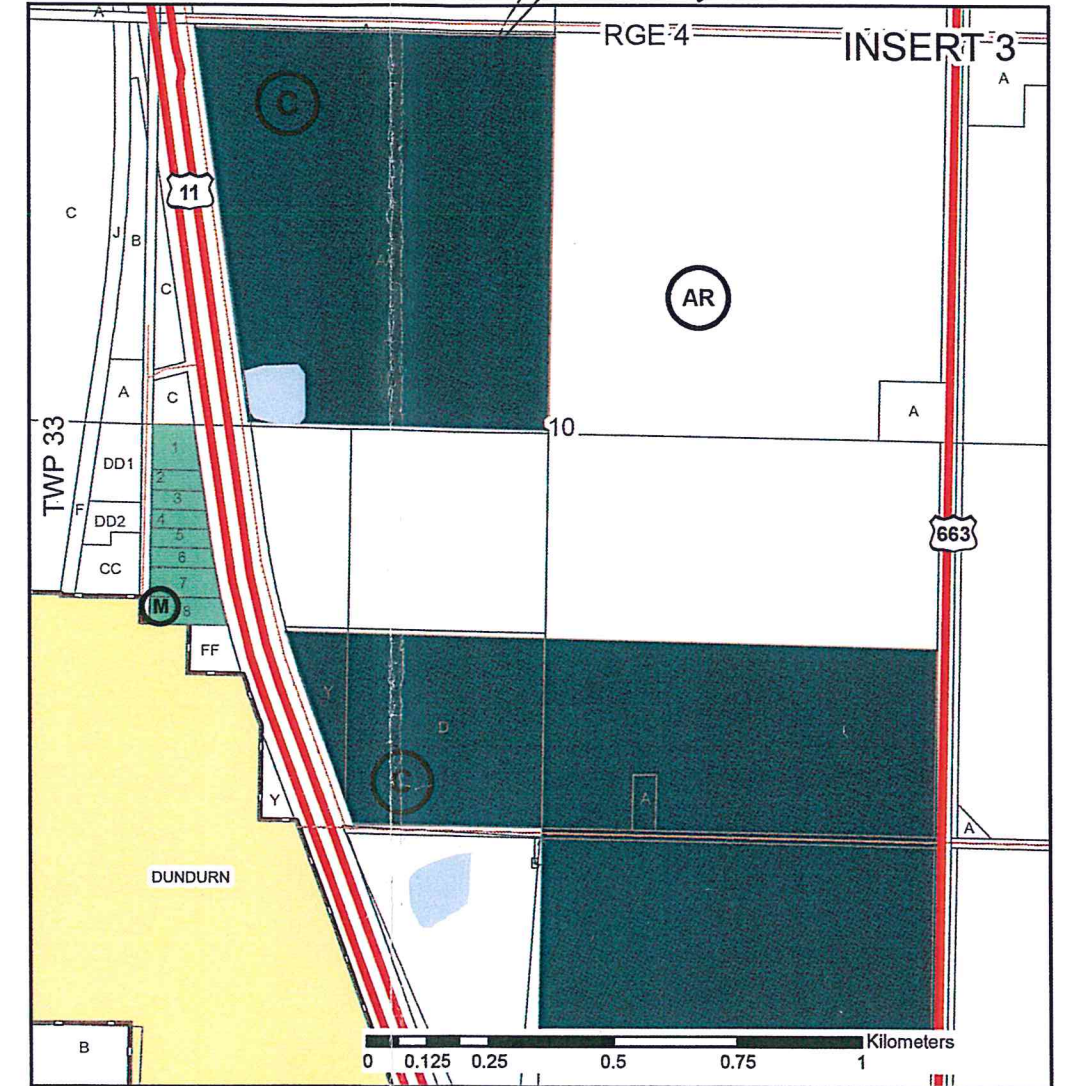
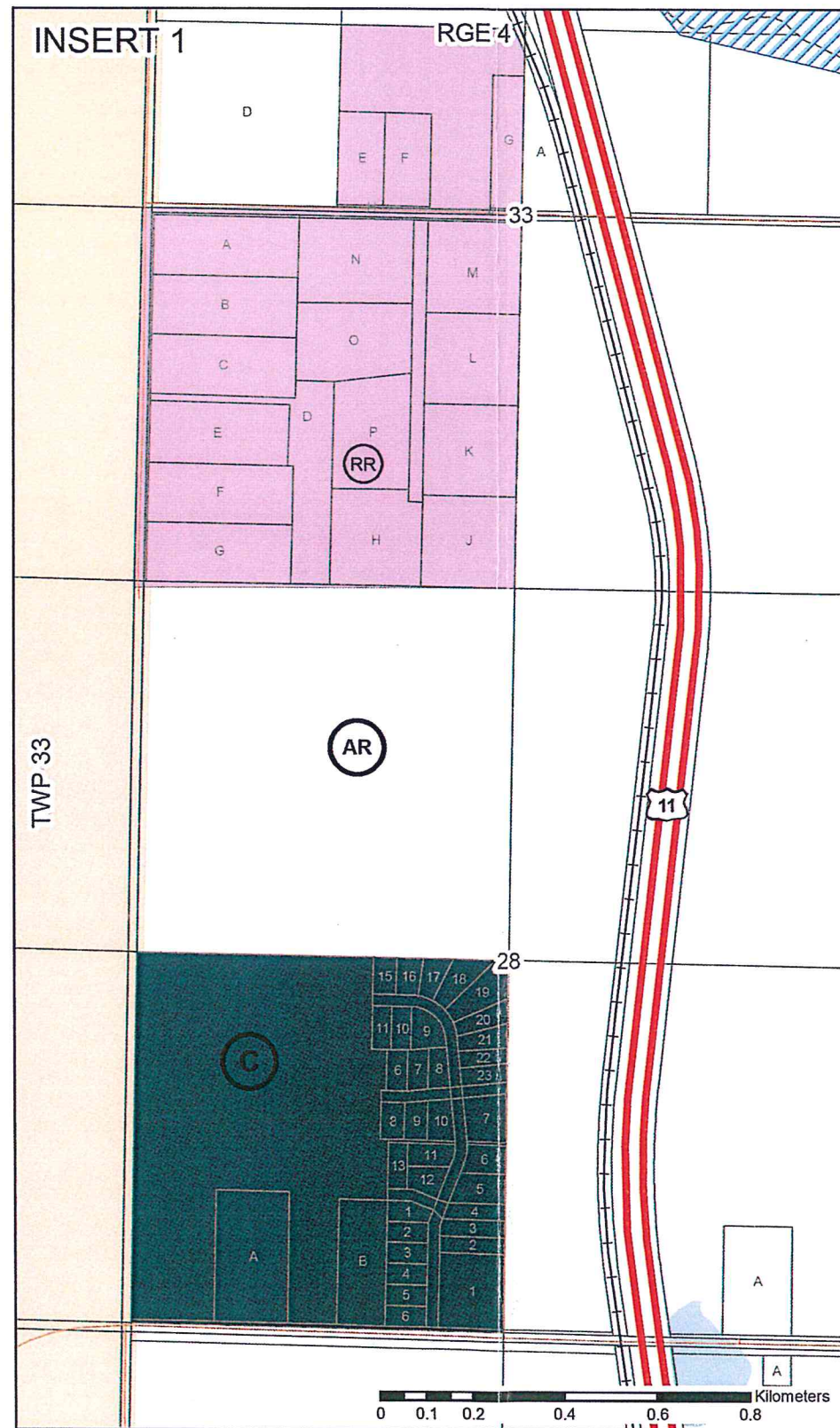
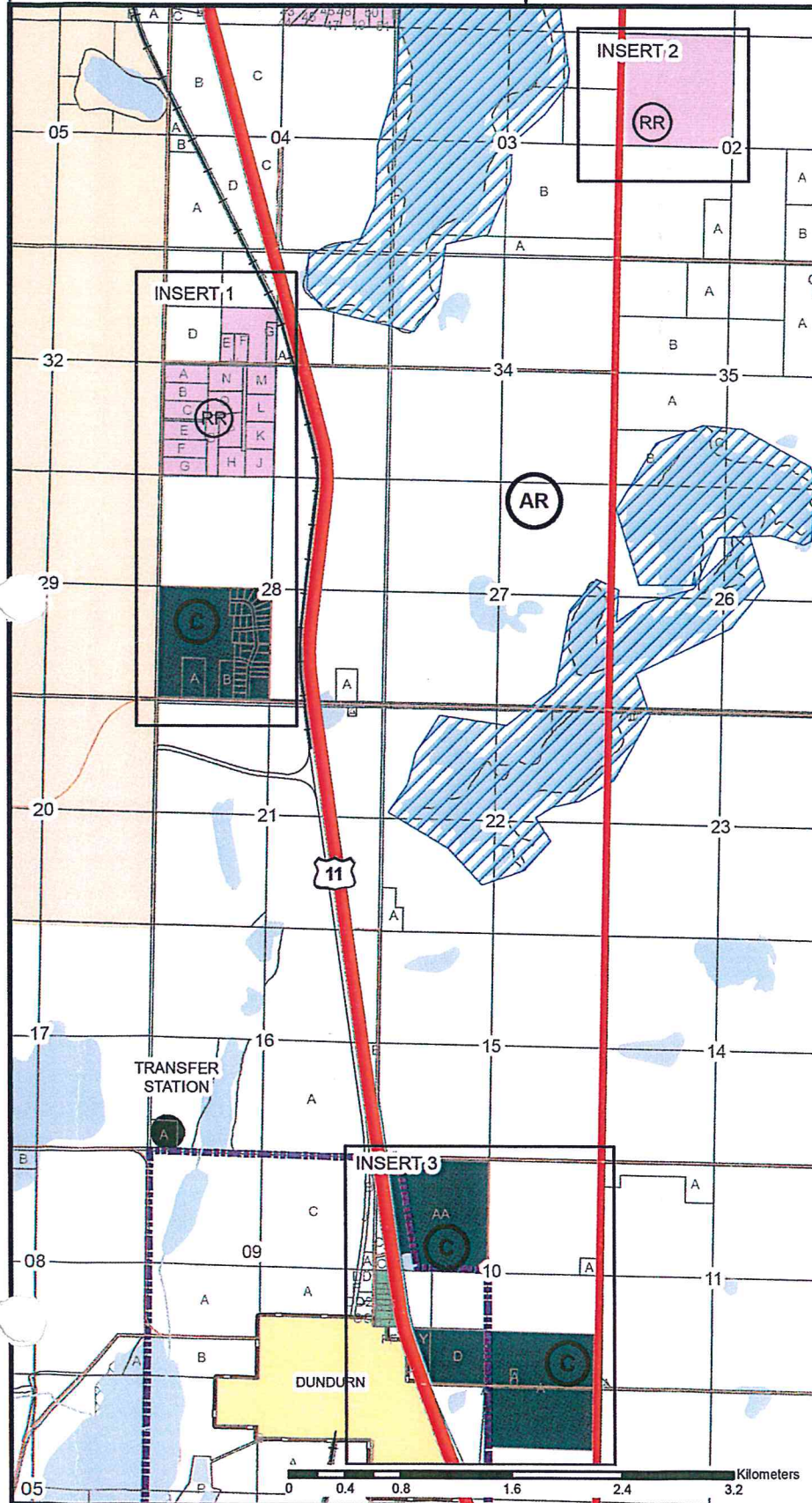

# Schedule A: Rural Municipality of Dundurn No. 314

## Zoning District Map D

### Zoning Districts

- PR - Public Recreation District
- RR - Rural Residential District
- CR - Commercial Recreation District
- IR - Institutional Recreation District
- BR - Blackstrap Residential District
- M - Industrial District
- AR - Agricultural Residential District
- C - Commercial District

- Main Roads
- Secondary Roads
- Railways
- Municipal Boundary
- Joint Planning Area
- Provincial Park
- RDA - Blackstrap Reservoir Development Area
- Watercourse
- Waterbody
- Potential Flood Hazard Areas
- Urban Municipalities

This is the Zoning District Map that accompanies Bylaw No. 03/2017 adopted by the R.M. of Dundurn No. 314

Administrator:

*[Signature]*  
Reeve:



W3M  
0 0.25 0.5 1 1.5 2 Kilometers

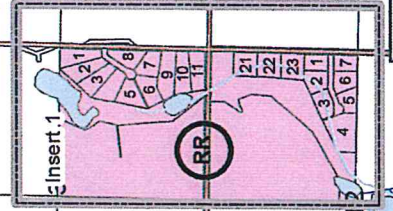
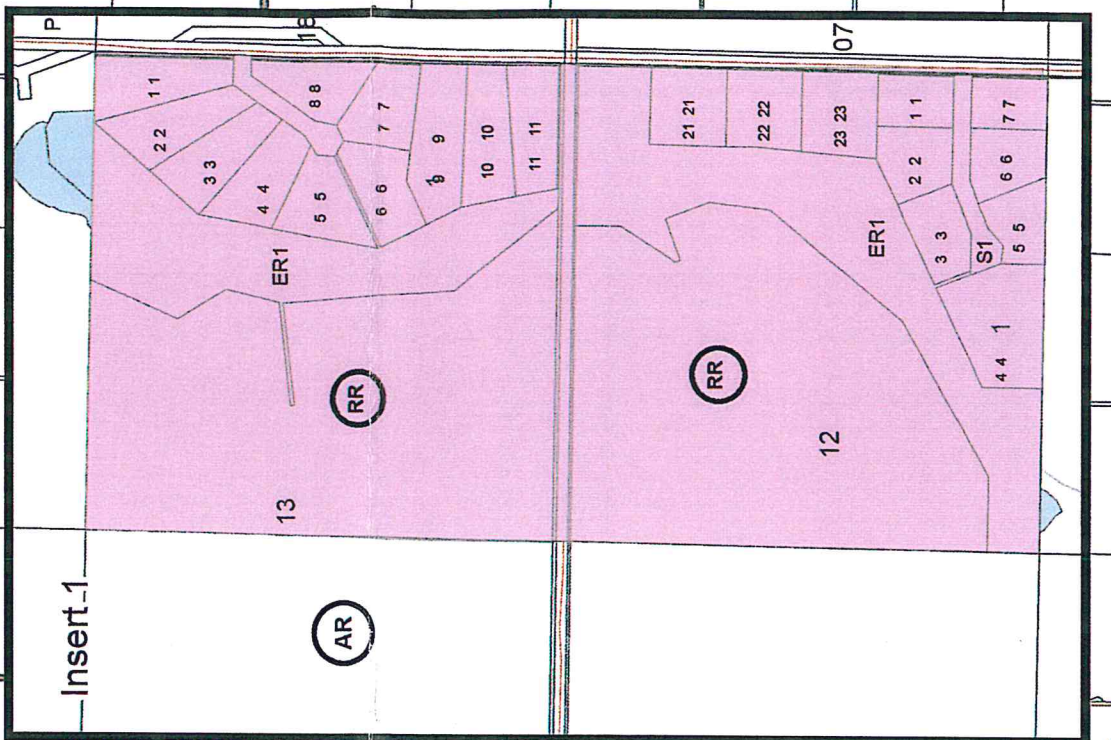
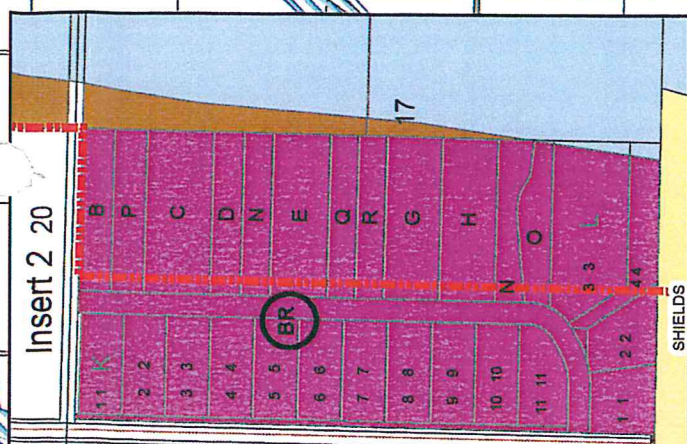
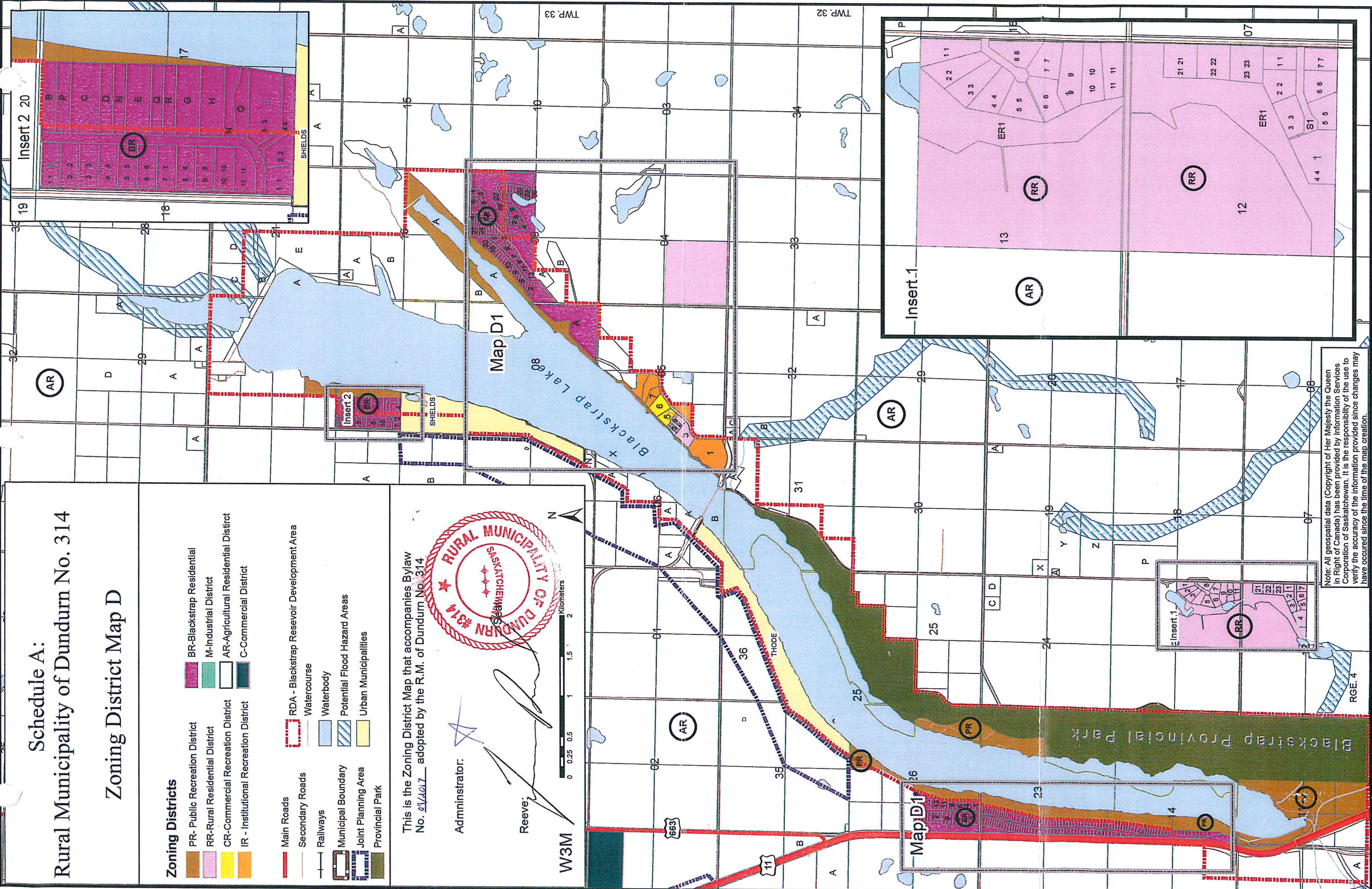

Note: All geospatial data (Copyright of Her Majesty the Queen in Right of Canada) has been provided by Information Services Corporation of Saskatchewan. It is the responsibility of the user to verify the accuracy of the information provided since changes may have occurred since the time of the map creation.

Schedule A:  
Rural Municipality of Dundurn No. 314

Zoning District Map D1



Zoning Districts

- PR- Public Recreation District
- RR-Rural Residential District
- CR-Commercial Recreation District
- IR - Institutional Recreation District
- BR-Blackstrap Residential
- M-Industrial District
- AR-Agricultural Residential Distriort
- C-Commercial District

- Main Roads
- Secondary Roads
- Railways
- RDA - Blackstrap Reservoir Development Area
- Watercourse
- Waterbody
- Urban Municipalities
- Potential Flood Hazard Areas
- Joint Planning Area
- Blackstrap Provincial Park

This is the Zoning District Map that accompanies Bylaw No. 69/2017 adopted by the R.M. of Dundurn No. 314

Adminstrator:

Reeve:



Seal

Note: All geospatial data (Copyright of Her Majesty the Queen in Right of Canada) has been provided by Information Services Corporation of Saskatchewan. It is the responsibility of the user to verify the accuracy of the information provided since changes may have occurred since the time of the map creation.

